



AirFold Powerchair

QUICK START GUIDE

1. Unpack powerchair and stand on its legs so it is standing in an upright folded position (A). Cut the nylon tie from the battery (B). Remove the rubber block from the battery (C) then firmly push the battery backwards until it locks in position with an audible click.

A



B

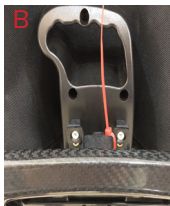

C

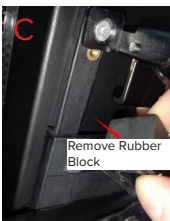

2. Lay the powerchair down, so that the four wheels are touching the floor. Unfold the powerchair by pulling on the backrest slowly whilst simultaneously pushing forward on the seat frame. Ensure the cables and lap belt are not trapped in the chair when unfolding.



3. When you hear a “click”, this indicates that the latch has been fixed into the locking pin and is now fully unfolded. It is important to ensure the latch below is locked to prevent the powerchair from folding.



4. Put freewheel levers into ‘Electric’ mode by pushing forward both levers towards the chair. Press in the latch and extend the anti-tip wheel backwards, on both sides of the powerchair.



5. Push down the flip up armrests and click into place.



6. Install joystick by choosing preferred side, then turn the securement knob to loosen and then insert the joystick tubing. When the required position is reached, tighten the knob to secure. Connect the 2 terminals ensuring ends are locked in place.



7. Add the cable clips to the side of the frame and press the long cable into the clip.



8. To remove battery (which is located under the seat) place your thumb over the back of the battery handle and fingers underneath until clip is located (or alternatively use two hands) , simply press / clench your fingers to pull the clip and simultaneously pull the battery to release it.



9. To insert battery. Slide the battery on to the rails underneath the seat. Push the battery firmly backwards until it locks in position with an audible click.



10. Install the seat cushion which attaches with velcro.



11. Pull-down footrest



12. Charge battery.
The battery can be charged via the powerchair by inserting the charger into the socket on the underside of the joystick.

Charging socket



The battery can also be charged directly when removed from the powerchair. (See section 8.2 of the Instructions for use for more details).



13. Ensure the charger is removed before operation and switch the powerchair on.



On/Off switch

14. After use, switch off (remove the battery if not using for more than 48 hours). Then simply fold by releasing and holding away the folding clip, and push forward on the backrest. Stand the chair up right and store in a suitable location.

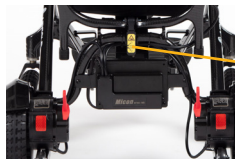

Folding clip

Follow these instructions to safely set up your new powerchair





Drive DeVilbiss Healthcare Ltd.
Sidhil Business Park, Holmfild, Halifax, West Yorkshire, HX2 9TN, GB

Tel: 0845 0600 333
Email: info@drivedevilbiss.co.uk
www.drivedevilbiss.co.uk

Drive DeVilbiss Sidhil Ltd.
4 Trench Road, Mallusk, Newtownabbey, BT36 4TY, UK



Sungo Europe B.V.
Fascinatio Boulevard 522, Unit 1.7, 2909VA Capelle aan den IJssel, NL



Sungo Certification Company Ltd
70 Gracechurch Street, London, EC3V 0HR, GB



Zhejiang Innuovo Rehabilitation Devices Co., Ltd.
196 Industry Road, Hengdian Movie Zone, Dongyang, Zhejiang, CN

Drive DeVilbiss Healthcare Ltd. provide this quick start guide.

NB. Images contained in this document are for illustration and parts identification purposes only, and may not reflect final product outlook appearance.